

Standard **Shower Kit**

Installation Guide

House Mount



www.CapeCodShowerKits.com

Ingredients

Post Cap		Cedar Braces	
Floor		Cedar Door Brace	
Cedar Post		Hardware Pack	

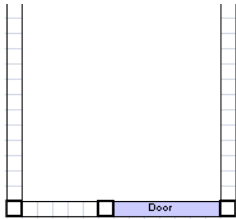

CUSTOM TIP:
Doors can be rotated on any side you choose!
Our kits are set up for altering doors + walls.

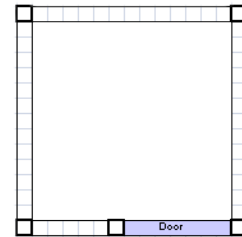

House Mount

- 2 Large Walls
 - 1 Small Wall
 - 1 Door
 - 3 - 8' Cedar Posts
- Optional: buy 2 extra posts for against the house*
- 3 Cedar Post Caps
 - 1 Cedar Floors
 - Cedar Corner Braces
 - 1 Hardware Pack
 - 1 Cedar Door Brace

Free Standing

- 3 Large Walls
 - 1 Small Wall
 - 1 Door
 - 5 - 10' Cedar Posts
- 10'ers for In Ground Install*
- 5 Cedar Post Caps
 - 1 Cedar Floor
 - Cedar Corner Braces
 - 1 Hardware Pack
 - 1 Cedar Door Brace

FOR MORE : TUTORIAL VIDEO IS ONLINE
<http://www.youtube.com/watch?v=4TkAj7VAHak>
or visit www.CapeCodShowerKits.com

Standard Installation

Above Ground & House Mount 8' Posts are used



DELIVERY IS OFFERED or Materials can fit in a Truck, SUV, or Van.



Choose your cedar posts and pick the best end for the top. Use a block or item to be reference for height for all posts. *For Above Ground:* Important tip to remember is to decide how high off the ground you want the kit positioned. Kits are Pre-Drilled.

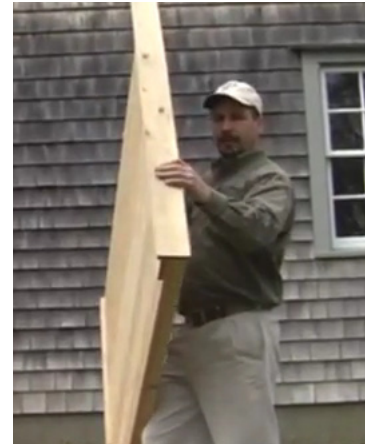

Our walls are built with rain guards. These will be the wider boards of the structure built in to the top of the wall. This part of the wall will be the top.



With the Pre-Drilled holes as reference use the Timberlocks™ in your Hardware Pack and connect a large wall to a cedar post. Make sure the inside of the wall is flush to the cedar post. Repeat for the second large wall.



Next, attach one wall to the house. Always making sure the wall is level. Then, measure one of the walls as reference to use for the space along the back side of the house for house mounting.

Standard Installation



Complete the second wall mount. Make sure the distance from the 1st wall mount is the right size (size of the wall panel) and level. Use a reference point against the wall or mark of with a pen / marker.

Then, install the second wall and make sure it is level.



Take the small wall and attach a cedar post to it - again making sure the height from the ground matches the other 2 walls. Add the small wall.

Drill the Timberloks™ at an angle for easier use.

Applying the Corner Braces:

Each Kit comes with corner braces. Use these at corners to act as added support for the 90 degree angle. Note: Screws are not in the hardware pack but any screw will do the trick.



Installing the Door: Use the hardware from the Hardware Pack and install on the door first. Then install the door. Keep about 1/4" between of each side of the door and the shower kit when securing the door.

Standard Installation



Getting Out:
After the door is installed and the latch is in place, add the string to the latch so that you don't get locked out.

That's it! Just add the finishing touches....and water!



FOR MORE : TUTORIAL VIDEO IS ONLINE
<http://www.youtube.com/>

Finishing Touches + Accessories



Cedar Door Brace
Complete the shower kit with the 2 x 4 Cedar Door Brace for added stability. Add this component at the top in between the posts that make up the door.



Custom Cedar Bench
Benches are offered as an option as well, hand crafted to match the durable quality of the cedar shower kit.



Floors & Post Caps

Add Floors and Post Caps to finish.
Post Caps Style:

Post Caps can be set tight against the top or they can rest higher. It depends how far the post comes off the top of the walls and how dig you deep the posts into the ground.

We recommend 7-12" for the space under the bottom of walls to ground.

NOTE: If you are in a windy area you may want to nail the post caps down and have an in-ground install with this kit.

**This demonstration is for above ground*



Congrats!

That's it! Just add the finishing touches....and water!



For More : Tutorial Video is Online
<http://www.youtube.com/watch?v=4TkAj7VAHak>