



Deluxe **Shower Kit**

Installation Guide

House Mount



Ingredients



Large Wall

Door

Small Wall

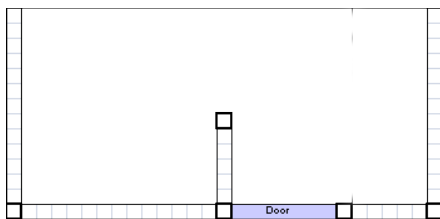

CUSTOM TIP:

Doors can be rotated on any side you choose! Our kits are set up for altering doors + walls.

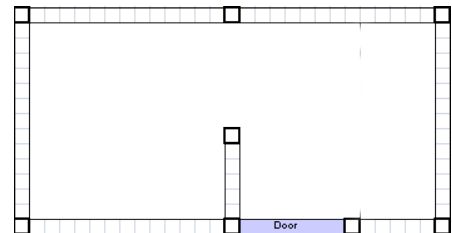

House Mount

- 3 Large Walls
- 2 Small Wall
- 1 Door
- 5 - 8' Cedar Posts
- Optional: buy 2 extra posts for against the house*
- 5 Cedar Post Caps
- 2 Cedar Floors
- Cedar Corner Braces
- 1 Hardware Pack
- 1 Cedar Door Brace

Free Standing

- 5 Large Walls
- 2 Small Wall
- 1 Door
- 8 - 10' Cedar Posts
- 10'ers for In Ground Install*
- 8 Cedar Post Caps
- 2 Cedar Floors
- Cedar Corner Braces
- 1 Hardware Pack
- 1 Cedar Door Brace

FOR MORE : TUTORIAL VIDEO IS ONLINE

<http://www.youtube.com/watch?v=4TkAj7VAHak>
or visit www.CapeCodShowerKits.com

Deluxe Installation

Above Ground & House Mount 8' Posts are used



DELIVERY IS OFFERED or Materials can fit in a Truck, SUV, or Van



Using Timberloks™ in Hardware Pack, attach a cedar post to large wall. Make sure the rainguard is on top (wider board).

For Above Ground: Important tip to remember is to decide how high off the ground you want the kit positioned. Make sure panel is flush to inside when mounting to post. Note: Kits are Pre-Drilled.



Add another cedar post to the other side of the large wall. Be sure both posts are aligned properly with each other. Next: Do the same for another large wall attaching 1 post only.



Important:
*Make sure all panels are level using a leveler.



Blue line shows a block to aid with install of 2 large walls.

Take your 2 Large Wall Panels, one with 2 posts and one with 1 post and drill them together.

A helpful tip here is to use a block that matches your desired kit height (from ground to bottom of the walls) as a staging piece when making the 90 degree connection.

Standard Installation



Always make sure inside of panels are flushed to inside of the post.



Again, make sure all panels are level.



CORNER BRACES:

Use these to make square and to provide support. Screws are not part of the pack for braces but any old screw in the house will do.

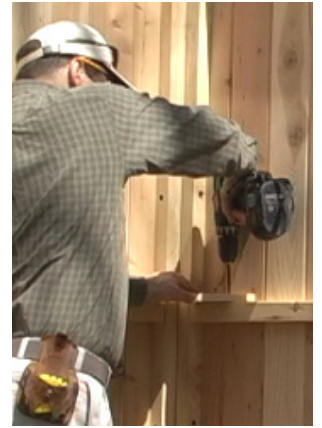

Continue along attaching another post to another large wall and drill the walls together.



After the last large wall is installed, use the small walls to create the interior splash and privacy area. The small walls will be at a perpendicular angle to each other.

TIP: Angle Timberloks™ for the small wall drills

Standard Installation



INSTALL THE HARDWARE:
Install the Hinges and Hardware for the door first.



INSTALL THE DOOR:
Keep at least 1/4" space on both sides of the door for best use.



Add the string to the latch so that you don't get locked out.

Finishing Touches + Accessories



Cedar Door Brace

Complete the shower kit with the 2 x 4 Cedar Door Brace for added stability. Add this component at the top in between the posts that make up the door.



Custom Cedar Bench

Benches are offered as an option as well, hand crafted to match the durable quality of the cedar shower kit.



Floors & Post Caps

Add Floors and Post Caps to finish.

Post Caps Style:

Post Caps can be set tight against the top or they can rest higher. It depends how far the post comes off the top of the walls and how deep you dig the posts into the ground.

We recommend 7-12" for the space under the bottom of walls to ground.

NOTE: If you are in a windy area you may want to nail the post caps down and have an in-ground install with this kit.

**This demonstration is for above ground*



Congrats!

That's it! Just add the finishing touches...and water!



For More : Tutorial Video is Online
<http://www.youtube.com/watch?v=4TkAj7VAHak>